

ITEM	QTY.	PART NO.	DESCRIPTION
* 1	1	87E119-00	BP1 CABLE ASSEMBLY
* 2	1	87E120-00	BN1 CABLE ASSEMBLY
* 3	1	57E370-00	BN1 CABLE ASSEMBLY
* 4	1	54E135-00	B01 CABLE ASSEMBLY
5	1	7N-0718	SWITCH ASSEMBLY
6	1	FB-MB1212-S	BATTERY BOX
7	1	87C242-00	BATTERY RACK BASE
8	1	52C173-00	BATTERY TIE DOWN
9	12	198-2970	FLANGED NUT - 3/8"-16
10	2	8T-4896	FLAT WASHER - 3/8"
11	2	6V-8801	HEX NUT - 3/8"-16
12	2	0170164	3/8"-16 X 3" FLATHEAD SS BOLT
13	1	1/4" PLYWOOD	41" X 9" - 1/4" PLYWOOD
14	2	153-5710	8D 24V BATTERY
15	10	PLT25-MO	MEDIUM TYRAPS - BLK
16	2	HRACKROD	3/8"-16 THREADED ROD - 14" LONG
17	2	248-4840	PROTECTIVE CAP
18	1	4882K17	1-1/2" PVC CLOSE NIPPLE
19	2	ECHA24112	1-1/2" FEMALE OZ BUSHING
20	1	KB7515-S	75 W 120 V BATTERY HEATING PAD
21	1	KB7515-D	75 W 120 V BATTERY HEATING PAD
22	1	BPC-61	POWER SUPPLY CORD
23	1	BY-T68	THERMOSTAT & Y CORD ASSY.
24	1	158-8021	2X4 WEATHERPROOF BOX
25	1	308-5524	15 AMP 120V GFI RECEPTACLE
26	1	334-7802	1/2" 90° LIQUIDTIGHT BOX CONNECTOR
27	1	334-7801	1/2" 45° LIQUIDTIGHT BOX CONNECTOR
28	60"	205-6419	1/2" LIQUIDTIGHT
29	1	BL-75	3/4" TIGER GRIP LOCKNUT
30	1	87E123	BATTERY BOX MODIFICATION DRAWING

\* MANUFACTURED UNDER "AMP500 BAT CABLES" WORK ORDER

TORQUE=16Nm  
BN1 CABLE ASSEMBLY (87E120)

TORQUE=16Nm  
BN1 CABLE ASSEMBLY (57E370)

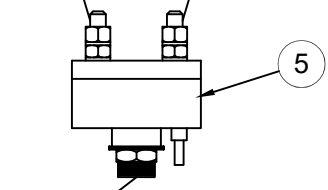

VIEW A-A BATTERY SWITCH  
SCALE=5

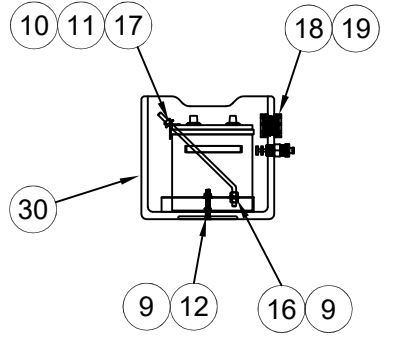

07/25/2013 D. ROLING	DATE		<b>ALTORFER POWER SYSTEMS</b> 6315 W. FAUBER RD.      PHONE (309) 697-1234 BARTONVILLE, IL 61607      FAX (309) 282-7546	
	BY		THIS DOCUMENT CONTAINS PROPRIETARY INFORMATION OF ALTORFER, INC. WITHOUT THE WRITTEN PERMISSION OF ALTORFER, INC., ANY COPYING OR OTHER USE EXCEPT THAT FOR WHICH IT WAS INTENDED IS PROHIBITED	
1 REVISE TO CORRECT PIN FOR #19	CHANGE NOTICE	FILE	PROJECT REFERENCE	
		DF15A	AMP500 MARITIME MODULE	
		SCALE/SHEET SIZE	DRAWN BY	QUOTE NUMBER
TOLERANCES:	THIRD ANGLE PROJECTION	1=10/D	D. ROLING	0
X.X ± 0.100	ANGULAR ± 1°	SHEET	DATE	WORK ORDER NUMBER
X.XX ± 0.060		1 OF 1	02/18/2013	0
X.XXX ± 0.005				
TITLE		MOUNTING GROUP - STARTING		DRAWING NUMBER
				87A208-01