

INCH 53A219-1

ITEM	QTY.	PART NO.	DESCRIPTION	WEIGHT
1	1	53B230	LIFT ARCH ASSEMBLY	245
2	8	8T-4994	FLAT WASHER 3/4"	-
3	8	1A-8063	BOLT 3/4"-10x2.50"	1
4	8	3B-4512	LOCK WASHER 3/4"	-
5	2	53B233	HEAT SHIELD-REAR	12
6	4	345-8531	WHIZLOCK BOLT 3/8"-16x1"	-
TOTAL				270

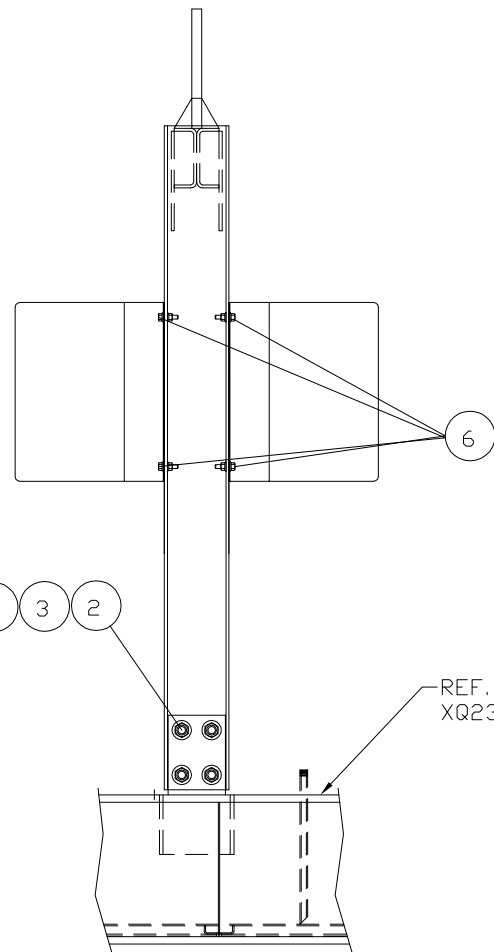
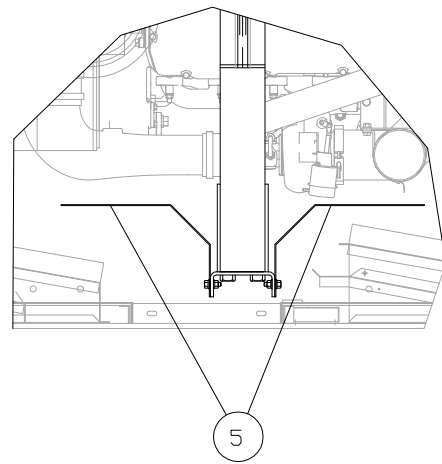

NOTE A- 4 3 2

REF. 53B200
XQ230/300 BASE AS.

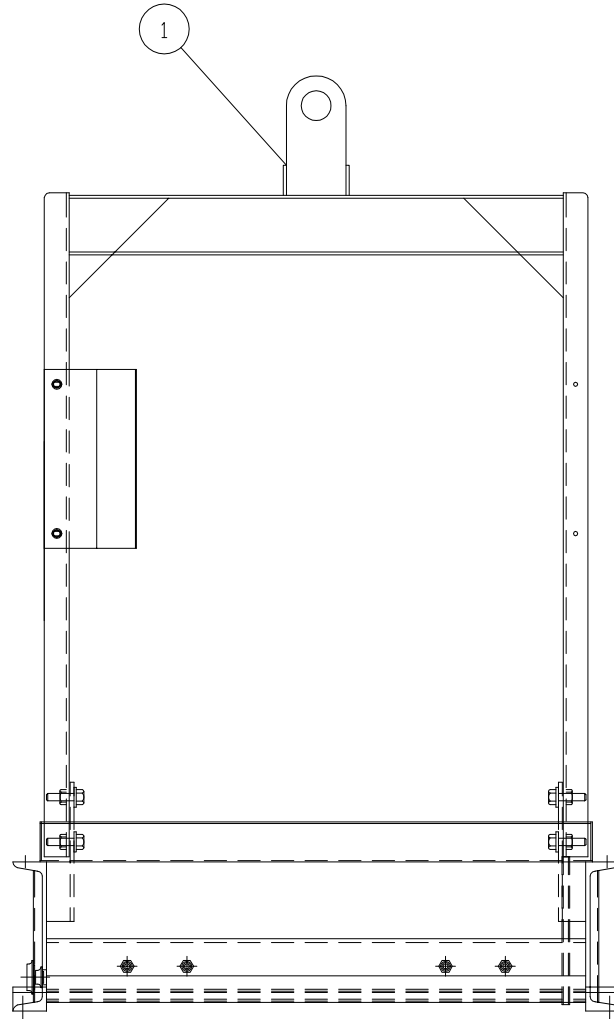

NOTE A: LEAVE LIFT ARCH MNT. BOLTS LOOSE UNTIL ENCLOSURE MNT. GP (53A220)

EXPORT UPDATE	CHANGE NOTICE	ALTORFER		ALTORFER POWER SYSTEMS			
		06-18-13 BML DATE BY		6315 W. FAUBER RD. PHONE (309) 697-1234 BARTONVILLE, IL 61607 FAX (309) 282-7546			
ND.		THIS DOCUMENT CONTAINS PROPRIETARY INFORMATION OF ALTORFER, INC. WITHOUT THE WRITTEN PERMISSION OF ALTORFER, INC., ANY COPYING OR OTHER USE EXCEPT THAT FOR WHICH IT WAS INTENDED IS PROHIBITED					
		ALL DIMENSIONS IN INCHES UNLESS OTHERWISE SPECIFIED		FILE DF/53A	PROJECT REFERENCE XQ230/300 APS230/300 RENTAL PACKAGE		
		TOLERANCES: X.X ± 0.100 X.XX ± 0.060 X.XXX ± 0.005	THIRD ANGLE PROJECTION	SCALE/SHEET SIZE 1=20/B	DRAWN BY BML	QUOTE NUMBER	
		ANGULAR ± 1°		SHEET 1 OF 1	DATE 06/10/08	WORK ORDER NUMBER	
		TITLE XQ230/300 APS230/300 LIFT ARCH GROUP			DRAWING NUMBER 53A219-1		